

sprchovacie dvere

MASTER B5

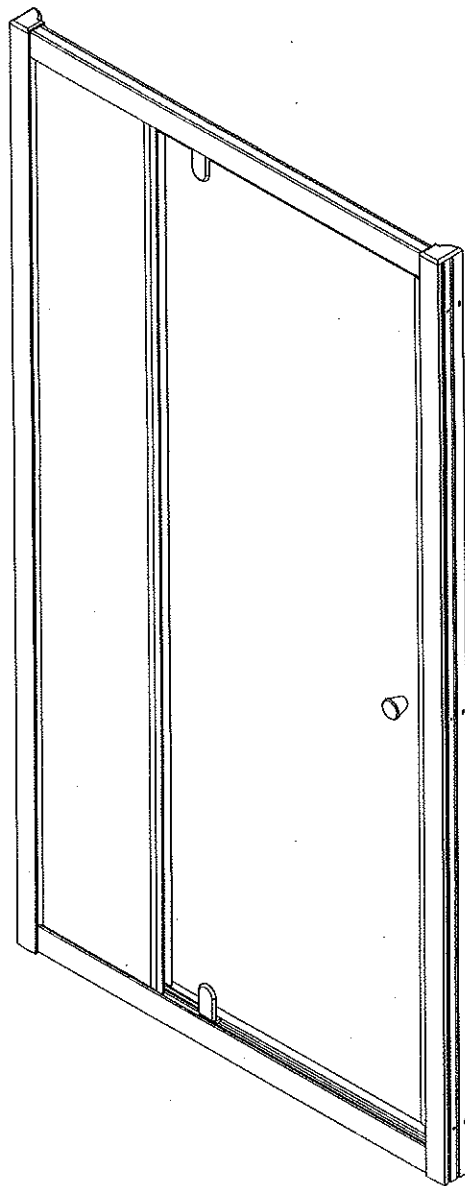

aquatek

Aquatek spol. s r.o. Topoľčany

Montážny návod

Pomocné náradie používané pri montáži sprchovacích dverí:

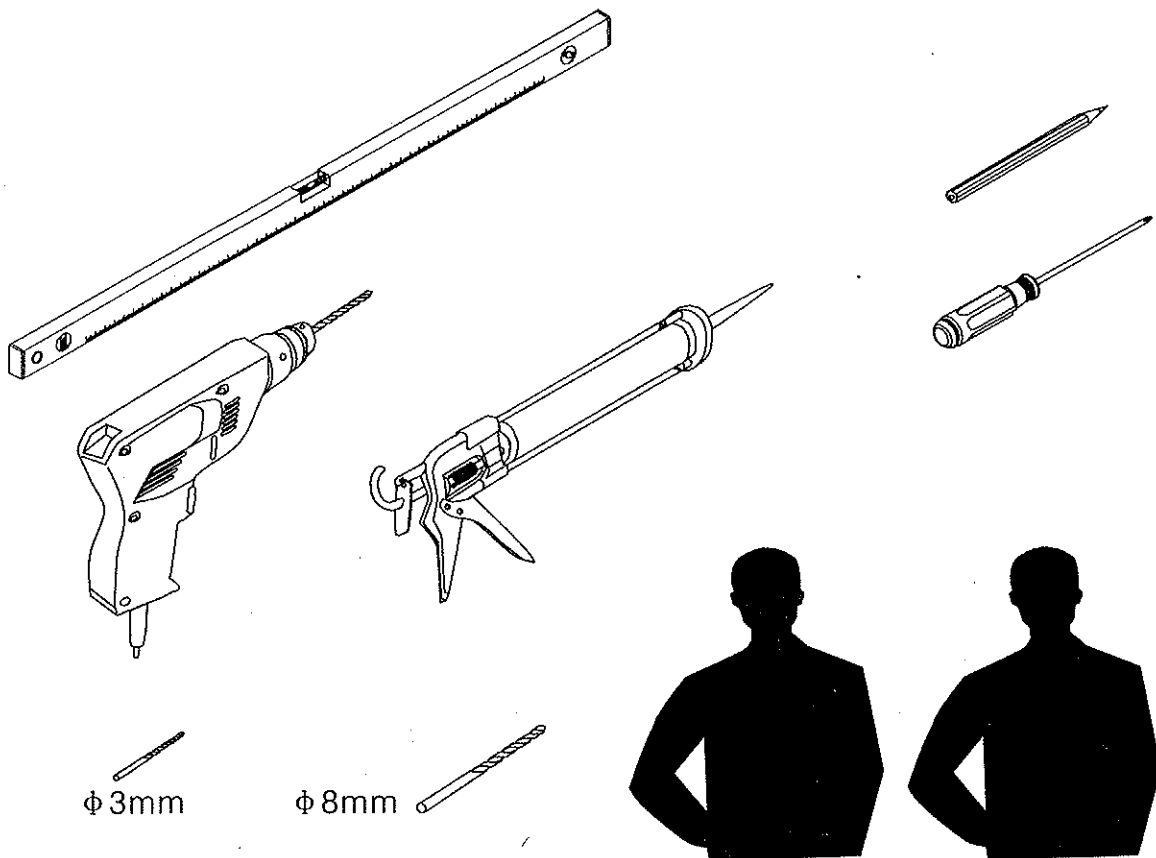

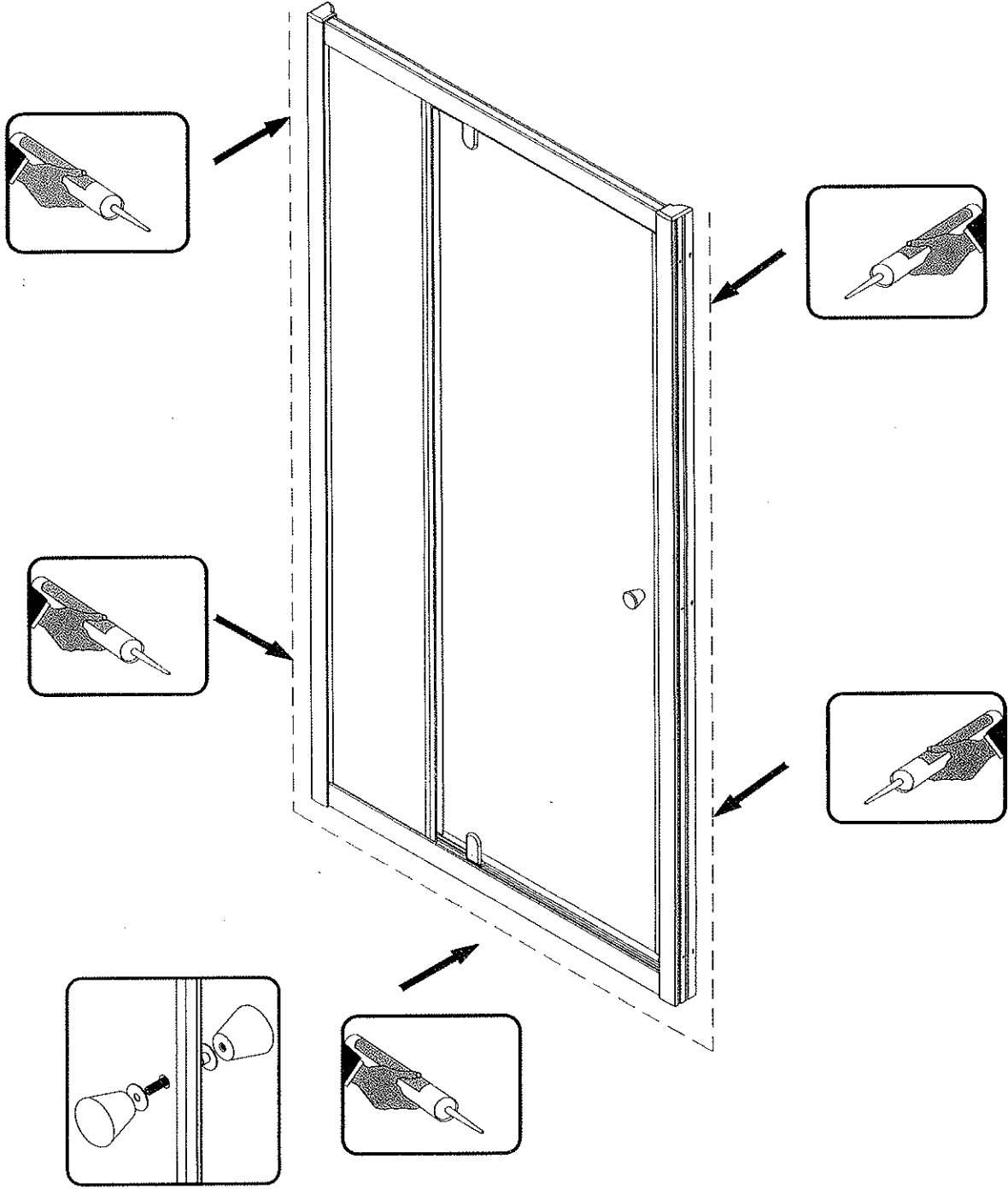

Upozornenie: K montáži sprchovacích dverí sú potrebné dve osoby.

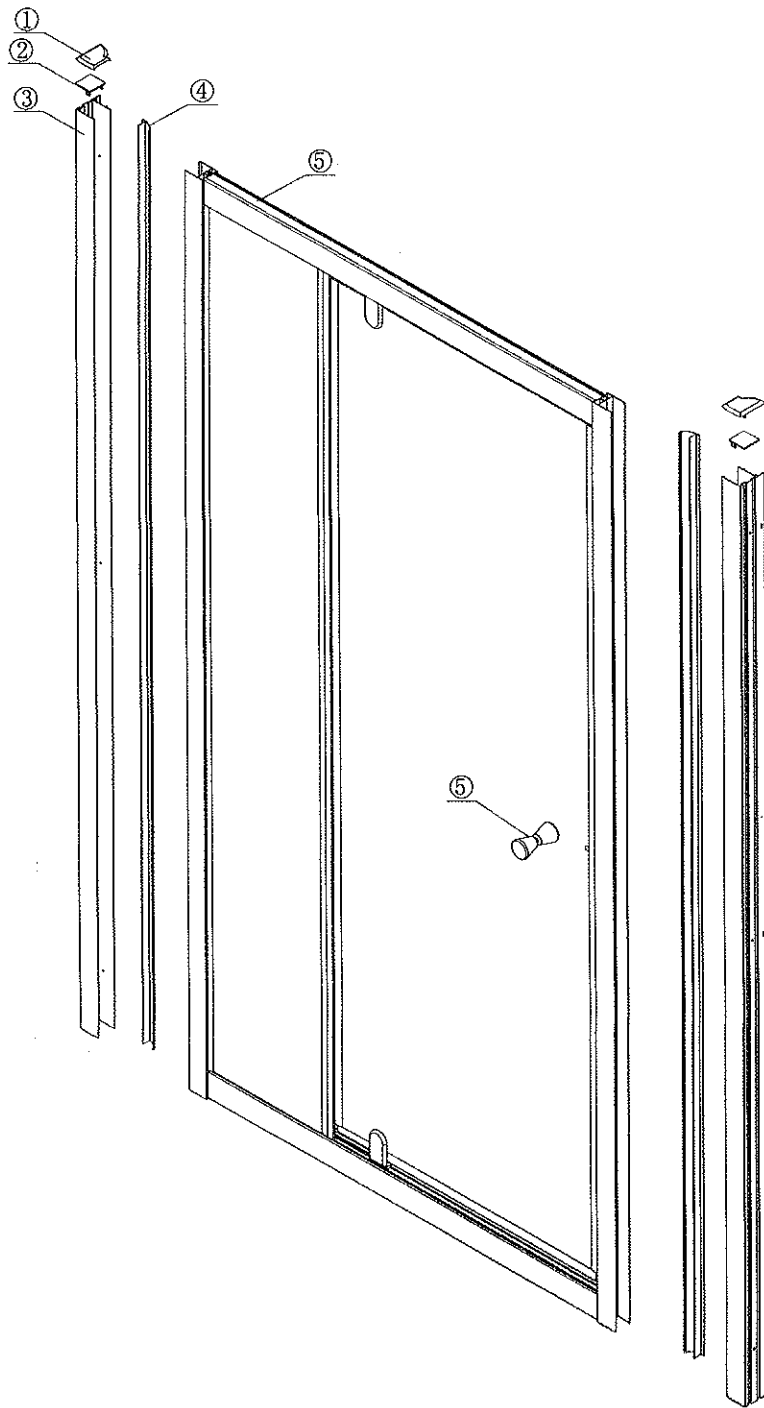

Upozornenie: K montáži sprchovacích dverí sú potrebné dve osoby.

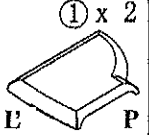
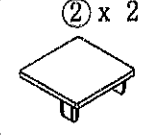
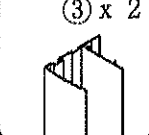
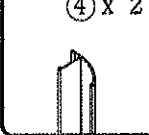
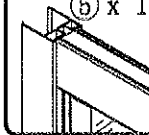
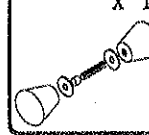

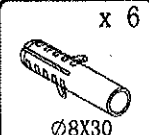
- | | | | | | | |
|---|--|--|--|---|--|---|
|  <p>① x 2
E P</p> |  <p>② x 2</p> |  <p>③ x 2</p> |  <p>④ x 2</p> |  <p>⑤ x 1</p> |  <p>x 1</p> |  <p>x 6
ST4X15</p> |
|  <p>x 6
ST5X30</p> |  <p>x 6
Ø8X30</p> | | | | | |



Upozornenie: K montáži sprchovacích dverí sú potrebné dve osoby

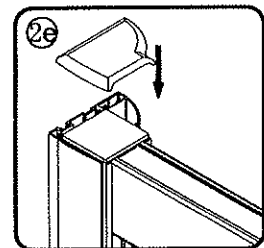
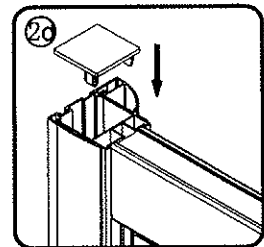
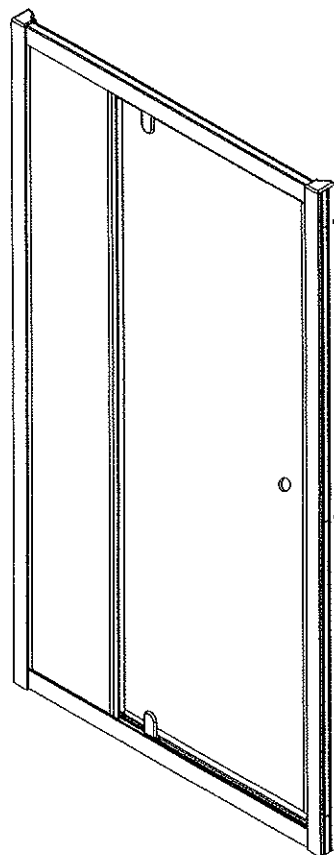
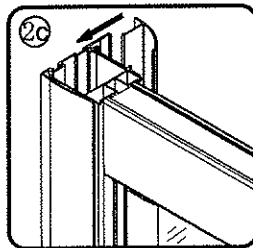
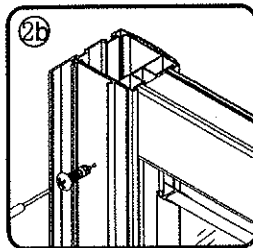
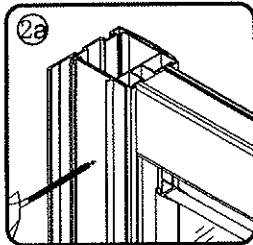
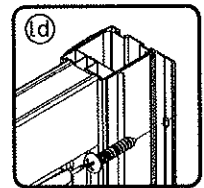
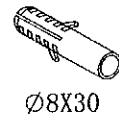
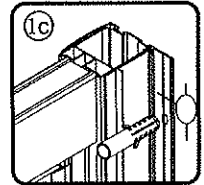
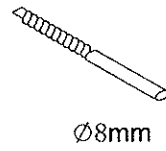
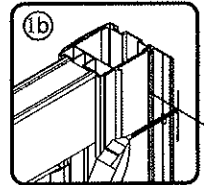
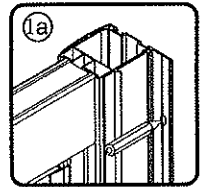
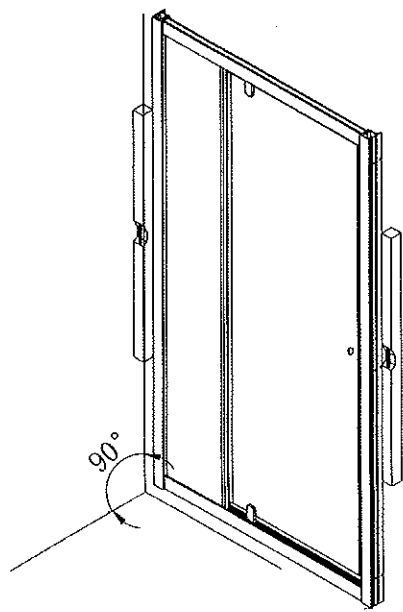

Upozornenie: K montáži sprchovacích dverí sú potrebné dve osoby.